

# daily neaty

## All-in-One Undergarment Washer-dryer

### Quick Start Guide

### Things to consider before installation



Note: Maintain enough distance for operation.

#### Placement

- ① The surface must be perfectly level and solid. Maintain a min. distance of 10cm between the washing machine and each edge of the surface.
- ② Install near the power supply and drainage.
- ③ Power cord is 1.5m in length.
- ④ Drain hose is 1.5m in length.

#### Accessories

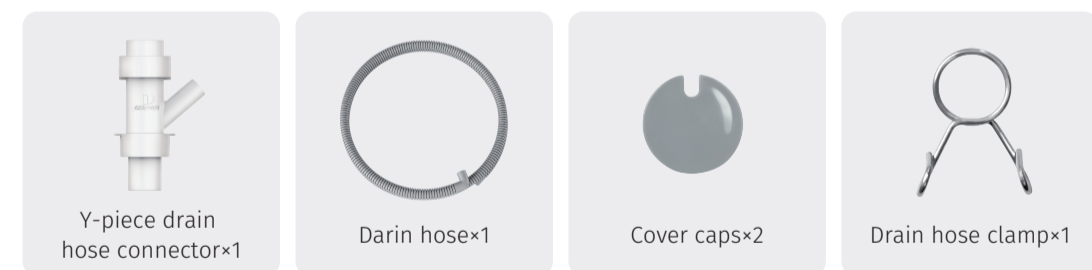

### How to install

#### STEP 1

##### Install water tank

Transit bolt holes

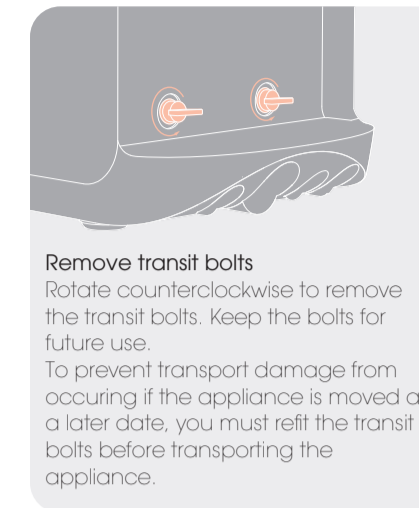

**Remove transit bolts**  
Rotate counterclockwise to remove the transit bolts. Keep the bolts for future use.  
To prevent transport damage from occurring if the appliance is moved at a later date, you must refit the transit bolts before transporting the appliance.

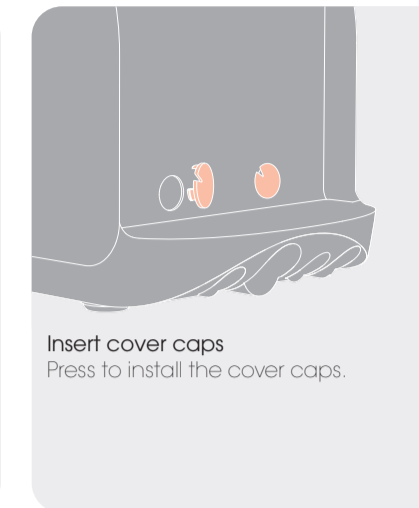

**Insert cover caps**  
Press to install the cover caps.

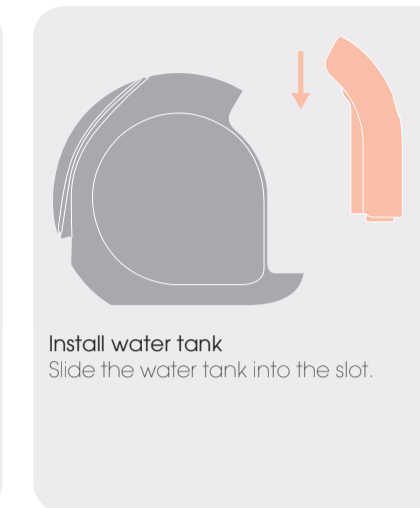

**Install water tank**  
Slide the water tank into the slot.

#### STEP 2

##### Install drain hose

Drain pump filter

Drain hose

Y-piece

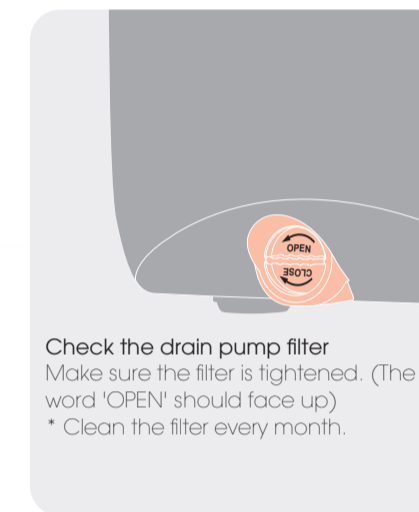

**Check the drain pump filter**  
Make sure the filter is tightened. (The word 'OPEN' should face up)  
\* Clean the filter every month.

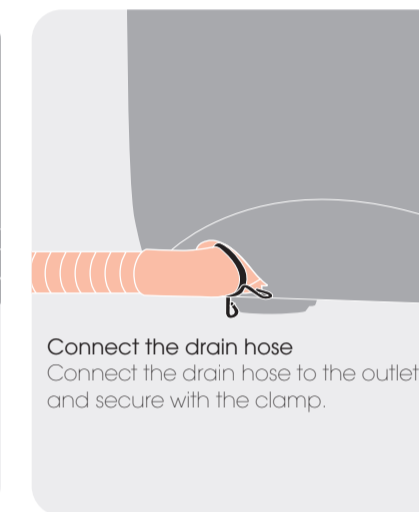

**Connect the drain hose**  
Connect the drain hose to the outlet, and secure with the clamp.

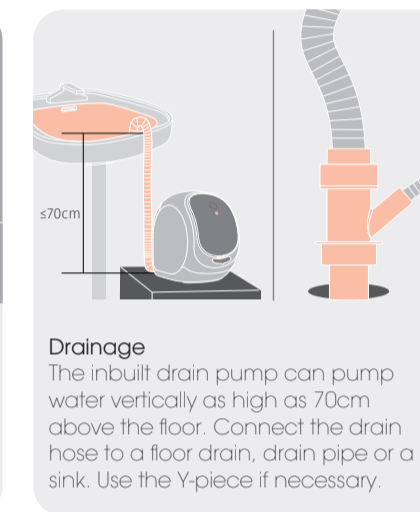

**Drainage**  
The inbuilt drain pump can pump water vertically as high as 70cm above the floor. Connect the drain hose to a floor drain, drain pipe or a sink. Use the Y-piece if necessary.

#### STEP 3

##### Install laundry detergent cartridge

Cartridge slot

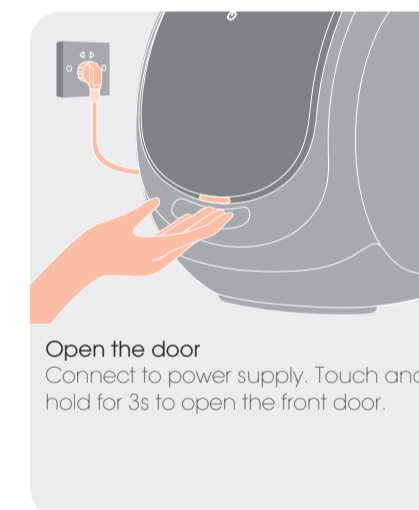

**Open the door**  
Connect to power supply. Touch and hold for 3s to open the front door.



**Insert the cartridge**  
Open the slot, remove the cover cap on the cartridge and insert. Push in the cartridge completely until you hear a clicking sound.



**Remove the foil seal**  
Remove the foil seal and close the slot cover.

#### STEP 4

##### Things to do before washing for the first time

Power button

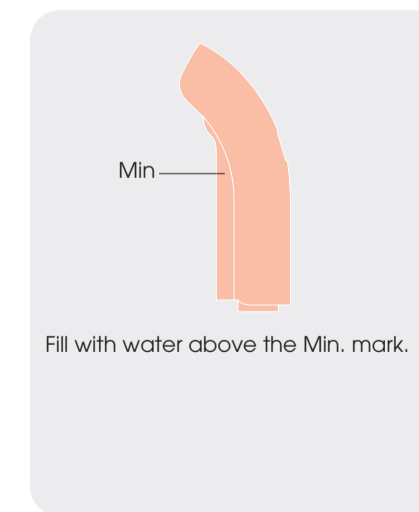

Fill with water above the Min. mark.

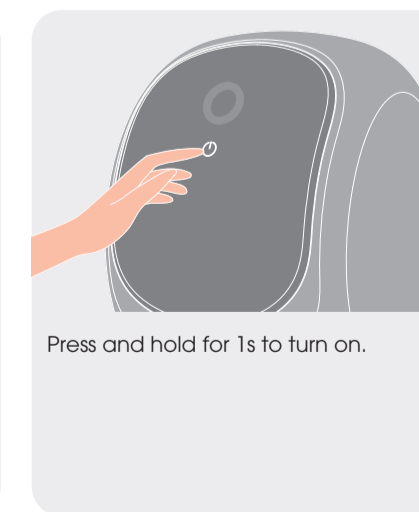

Press and hold for 1s to turn on.



Run Drum Clean without any laundry. Check the inlet and outlet connections to prevent water leakage.